

# thaMographe<sup>®</sup>

## Notice d'utilisation

### Tracer un cercle

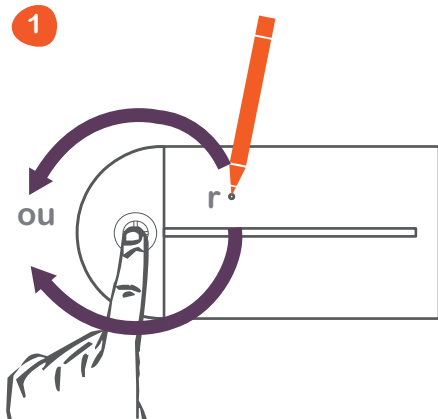

2 Résultat :

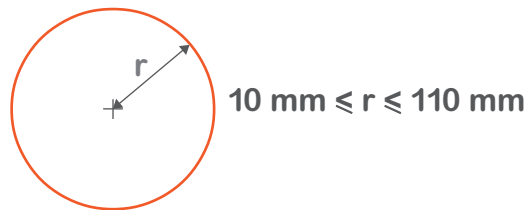

Remarque : il est possible de tracer un cercle entier sans lever le crayon.

### Tracer deux segments formant un angle

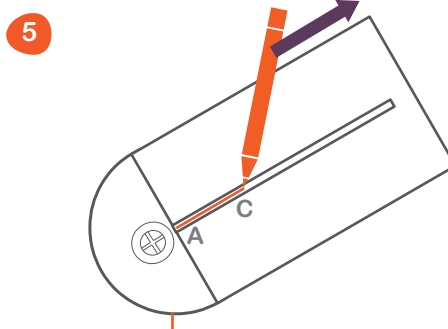
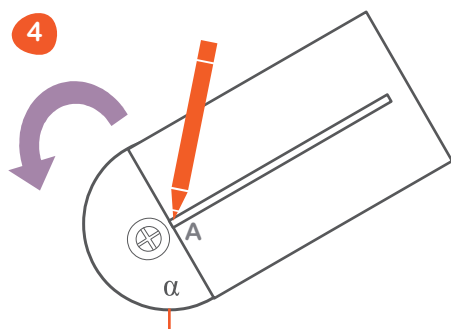
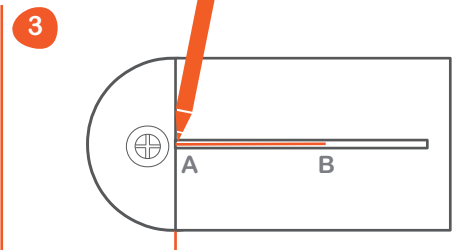
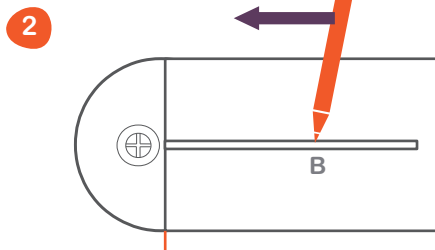
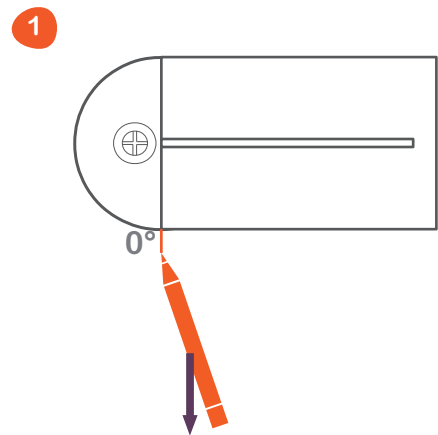

6 Résultat :

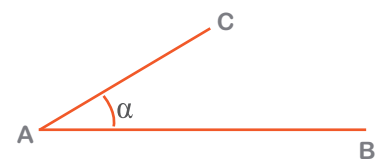

## Tracer une parallèle

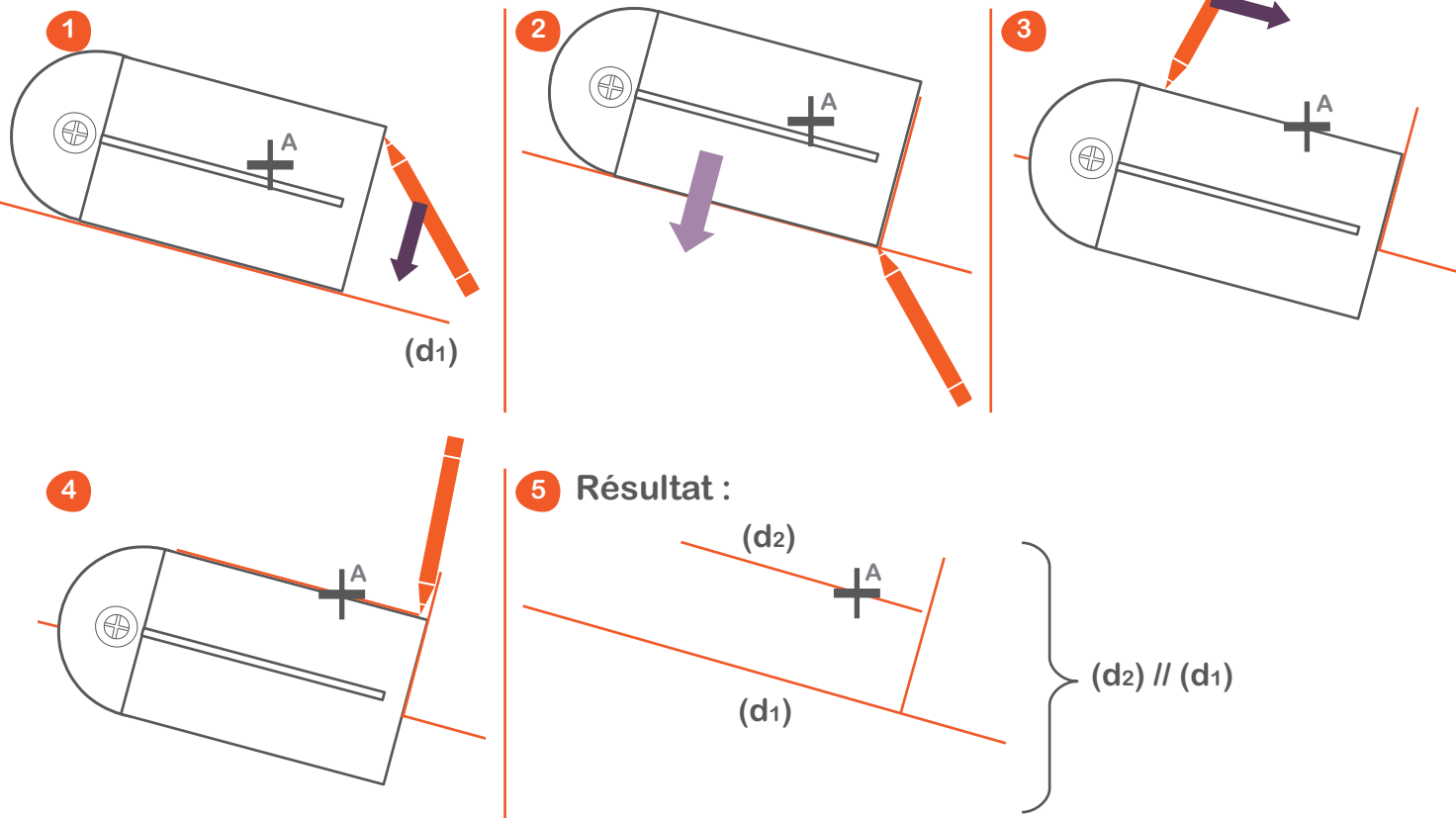

## Tracer un polygone régulier

Principe :

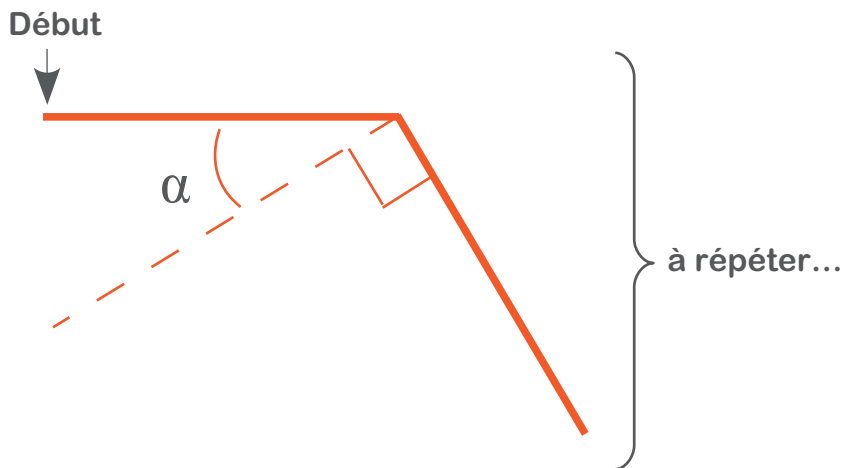

Choix de l'angle  $\alpha$  : ( $n$  = nombre de côtés)

Formes	n	$\alpha^\circ$
Carré	4	0
Pentagone	5	18
Hexagone	6	30
Heptagone	7	38,5
Octogone	8	45
Ennéagone ou Nonagone	9	50
Décagone	10	54
Hendécagone	11	57
Dodécagone	12	60
Polygone à n côtés	n	$90 - (360/n)$

Exemples :

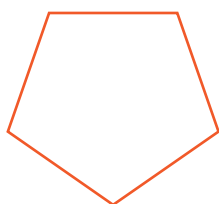

$n = 5$

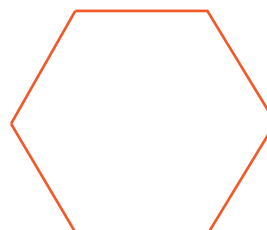

$n = 6$

# Tracer un polygone régulier

Avec le **thaMographe**

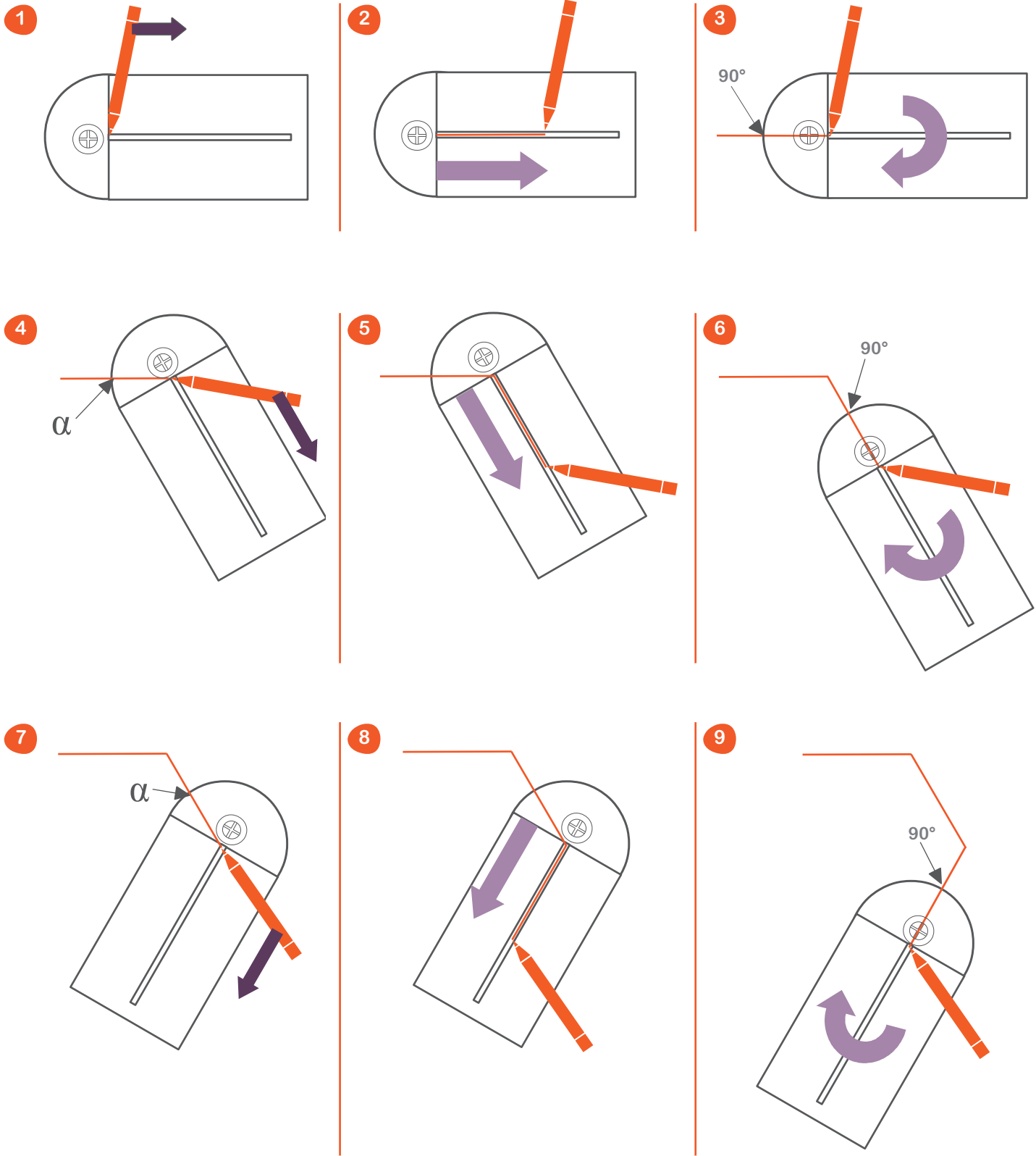

et ainsi de suite...



Pour plus d'informations,  
flashez et visualisez  
nos vidéos  
de démonstration.